

Unleash the Magic: Discover the Secrets of Swappable Battery Smoke Machines!

Swappable battery-operated smoke machines have taken the event and entertainment industry by storm, offering a unique blend of portability and functionality. Whether it's a theatrical production, a wedding, or a lively party, these machines can create an enchanting atmosphere that captivates audiences. Unlike traditional smoke machines tethered to power outlets, the swappable battery models provide the freedom to operate in various environments without the hassle of cords and cables. In this article, we'll delve into how these innovative devices work, explore their myriad benefits, share practical usage tips, and provide recommendations to help you choose the right machine for your needs.

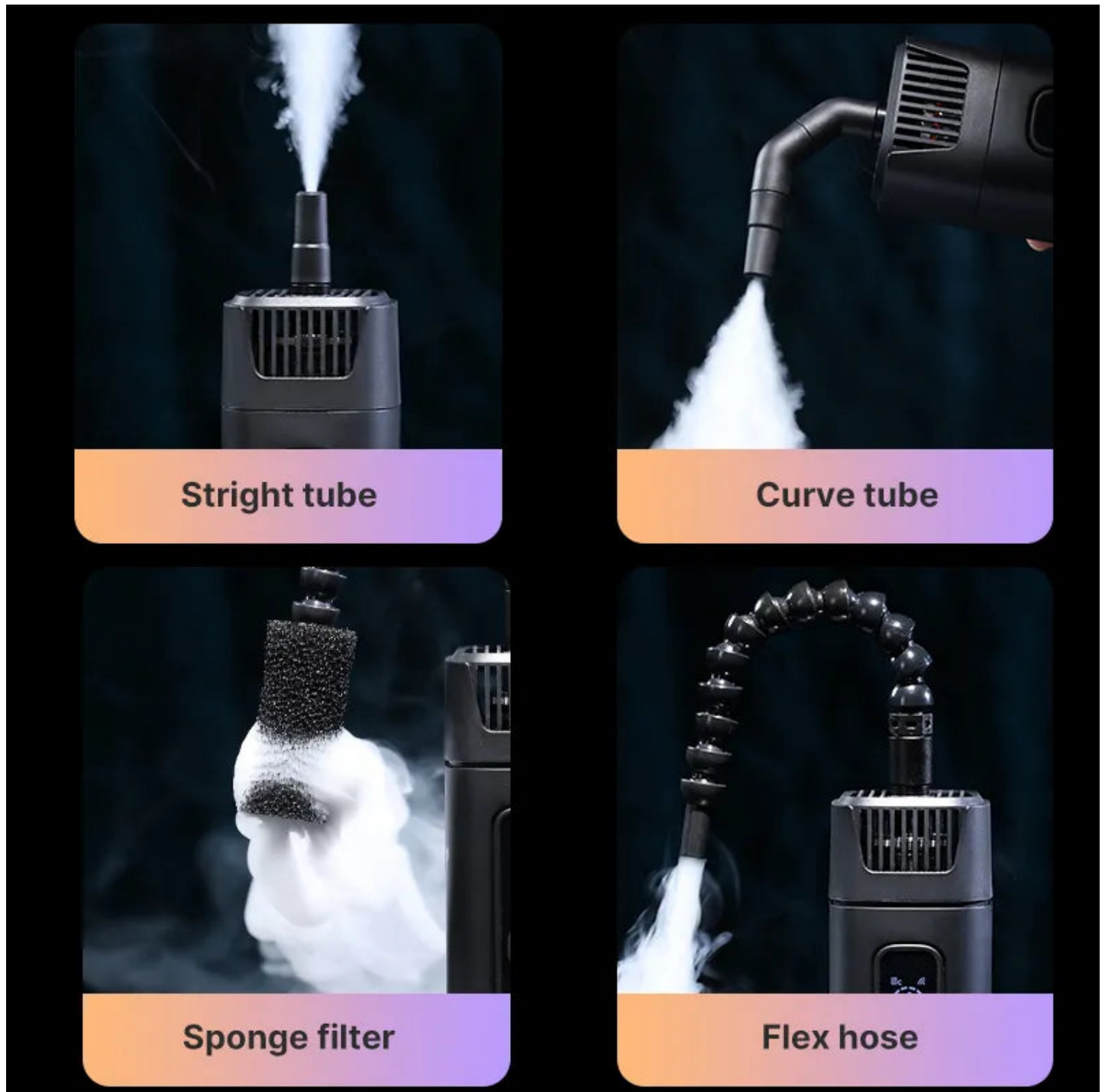

Understanding Swappable Battery-Operated Smoke Machines

At the heart of [swappable battery-operated smoke machines](#) lies a simple yet effective mechanism. These machines utilize a combination of battery power and specialized smoke fluid to generate fog. The battery serves as a power source, heating the smoke fluid in a chamber until it vaporizes, producing the desired smoky effect. The technology behind these machines is designed for portability, allowing performers and event planners to create stunning visuals without being limited by power source availability. The swappable battery feature is particularly advantageous, enabling users to quickly replace a depleted battery with a charged one, ensuring uninterrupted operation even during extended events.

Benefits of Using Swappable Battery Smoke Machines

The advantages of using swappable battery-operated smoke machines over traditional models are numerous. First and foremost, their portability allows them to be used in any setting—be it an indoor venue, an outdoor festival, or even at private gatherings without the need for a nearby electrical outlet. This flexibility means that you can set the mood wherever you are. Safety is another significant benefit; since these machines do not rely on high-voltage power, there's a lower risk of electrical hazards, making them suitable for a variety of environments. Furthermore, the user-friendly design of battery-operated machines means that even those without technical expertise can operate them with ease, allowing anyone to create captivating effects without a steep learning curve.

Tips for Using Swappable Battery Smoke Machines

To maximize the effectiveness of your swappable battery smoke machine, there are several practical tips to keep in mind. First, ensure that you fully charge the battery before your event to avoid any interruptions. When setting up the machine, choose a location that allows for adequate airflow to enhance the dispersion of the smoke. It is also crucial to use the recommended smoke fluid to ensure optimal performance and avoid damaging the machine. Regular maintenance, such as cleaning the fluid nozzles and checking battery connections, will help in prolonging the lifespan of your smoke machine. Additionally, always have a troubleshooting checklist on hand—common issues like low output or uneven smoke distribution can usually be resolved quickly with a few simple adjustments or by replacing the battery.

Recommendations for Choosing a Swappable Battery Smoke Machine

When selecting a swappable battery-operated smoke machine, several factors should guide your decision. First, consider the battery life; a longer-lasting battery will allow for extended use without frequent interruptions. Look for machines that offer adjustable smoke output settings, providing flexibility for different events. The ease of use is also essential; machines with intuitive controls and clear instructions will make setup a breeze. Additional features such as built-in timers or remote controls can enhance the user experience, allowing for seamless operation during performances. Don't hesitate to consult user reviews and experiences to find a machine that meets your specific needs, ensuring you invest in a reliable option.

Creating Enchanting Atmospheres with Smoke Machines

In summary, swappable battery-operated smoke machines are a game-changer in the realms of event planning and performance, offering unmatched portability, safety, and ease of use. By understanding how they work, recognizing their benefits, and applying practical tips for usage, you can elevate the atmosphere of any gathering. With careful consideration of your needs when choosing a machine, you'll be well on your way to creating magical moments filled with enchanting fog. Embrace the possibilities that these innovative devices offer, and let your creativity shine!