

## Unlock the Secrets: How Variable Intensity Smoke Machines Transform Your Experience!

Smoke machines have surged in popularity, becoming a staple in a variety of settings, from theatrical performances to parties and photography shoots. These machines create an atmospheric effect that captivates audiences and enhances visual presentations. However, not all smoke machines are created equal. Those equipped with [variable intensity settings](#) allow users to control the density and volume of smoke produced, tailoring the experience to fit specific needs. In this article, we will delve into the benefits and functionality of smoke machines with variable intensity settings, revealing how they can transform any occasion into a memorable experience.

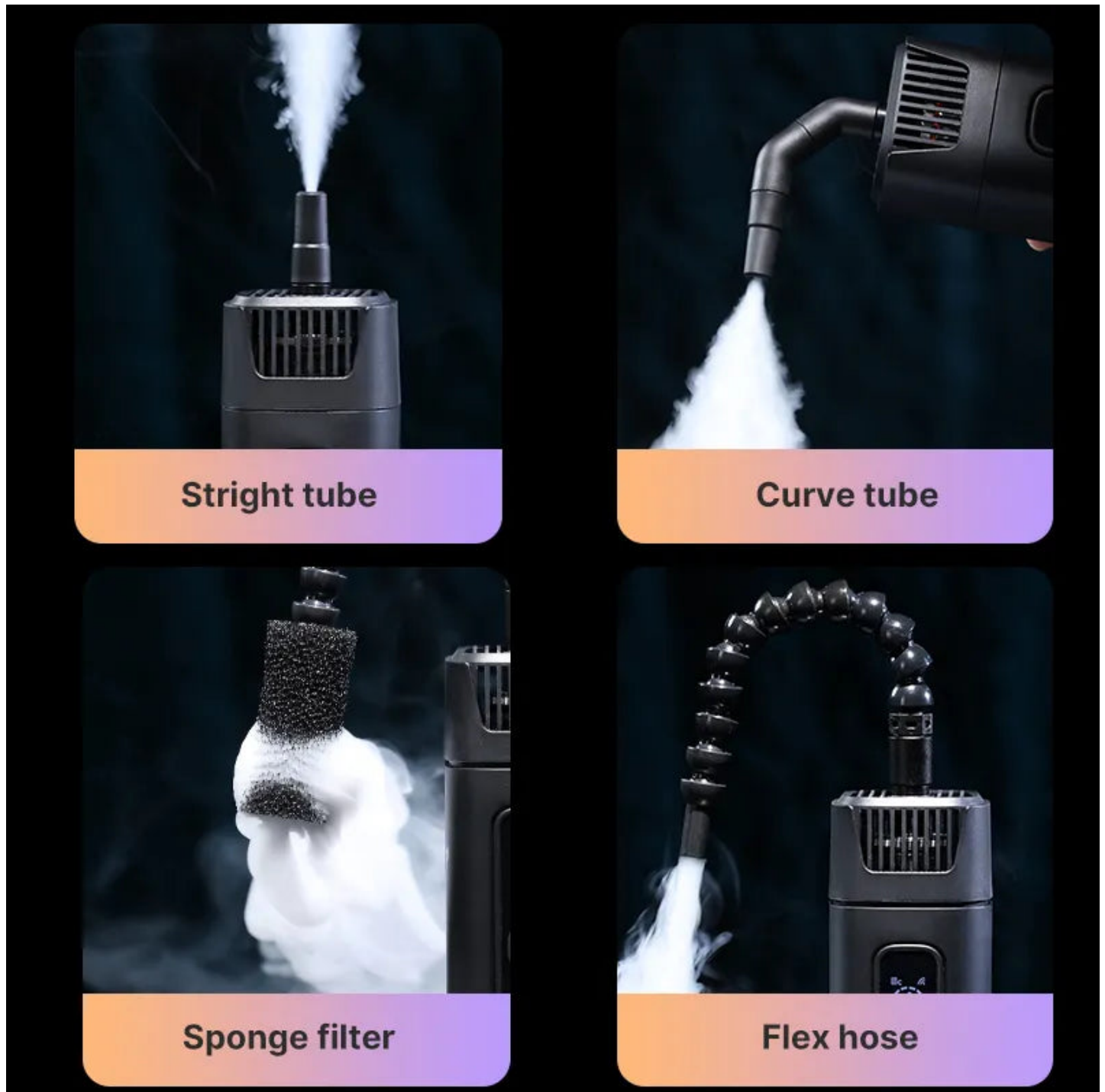

### Understanding Smoke Machines

Smoke machines, also known as fog machines, are devices that produce vaporized liquid to create a fog-like effect. They work by heating a special fluid, which is then expelled through a nozzle, producing a cloud of smoke that can fill a room or stage. There are various types of smoke machines available on the market, including compact models for personal use and larger units designed for professional applications. Some machines use water-based fluids, while others utilize oil-based solutions, each with distinct characteristics in terms of density and longevity of the smoke produced. Understanding these differences is crucial for selecting the right machine for your needs.

### The Importance of Variable Intensity Settings

Variable intensity settings are a game-changer in the world of smoke machines. These settings allow users to adjust the output of smoke, providing greater control over how much fog is produced at any given time. This is particularly important in scenarios where ambiance is key; for instance, a subtle haze can enhance the dramatic lighting of a stage performance, while a thicker fog might be necessary for a Halloween event or a dance party. The ability to customize smoke intensity ensures that the effect can match the mood and theme of the event perfectly, making it a valuable feature for any user.

## **Benefits of Using Smoke Machines with Variable Intensity**

Using smoke machines equipped with variable intensity settings offers numerous advantages. Firstly, these machines provide versatility; whether you're hosting an intimate gathering or a large-scale event, you can easily adjust the smoke output to suit the setting. Secondly, the enhanced visual effects created by controlling smoke density can significantly elevate the aesthetic appeal of performances or displays. Finally, tailored experiences become possible, allowing users to create the perfect atmosphere for different occasions. For instance, at a friend's wedding, we used a smoke machine with variable intensity to create a romantic ambiance during the first dance, leaving everyone in awe.

## **Applications in Different Settings**

Variable intensity smoke machines find applications across a wide range of environments. In theatrical performances, they can be used to simulate foggy landscapes or create dramatic effects during key scenes. At events and parties, they serve to enhance the atmosphere, whether it's a themed gathering or a concert. In photography, a light haze can add depth and texture to images, making them more visually appealing. I remember attending a friend's art show where a smoke machine was used to create a mystical vibe, perfectly complementing the artwork on display. The variable intensity setting allowed the artist to control the effect throughout the evening.

## **Tips for Choosing the Right Smoke Machine**

When selecting a smoke machine with variable intensity settings, there are several factors to consider. First, assess the size of the machine; larger units may be more suitable for expansive venues, while smaller models can be ideal for home use. Next, consider the output capacity; higher output machines are better for large crowds, while lower output machines can work well in smaller settings. Finally, ease of use is vital; look for machines with user-friendly controls that allow you to adjust settings effortlessly. A friend once shared how choosing the right size and output made all the difference in the success of their event.

## **Maximizing Your Experience with Smoke Machines**

In conclusion, smoke machines with variable intensity settings offer a wealth of benefits and functionalities that can significantly enhance experiences across various scenarios. By allowing users to control the density and volume of smoke, these machines enable tailored atmospheres that suit any occasion, from theatrical performances to personal celebrations. Investing in a smoke machine with variable intensity settings can elevate your events and create lasting memories, making it a valuable addition to your toolkit.