

Unleash Your Creativity: Discover the Ultimate Portable Smoke Machines for Stunning Effects!

In recent years, portable smoke machines have gained significant traction in creative industries such as photography, live events, and theatrical performances. These devices bring an extra layer of depth and mood to visual storytelling, allowing artists and event planners alike to explore their creative potential. The ability to customize smoke effects is particularly appealing, as it enables users to tailor each moment according to their unique vision or theme. Whether you are trying to create a mysterious atmosphere for a photoshoot or add dramatic flair to a live performance, a portable smoke machine with [tailorable effects](#) can be a game-changer.

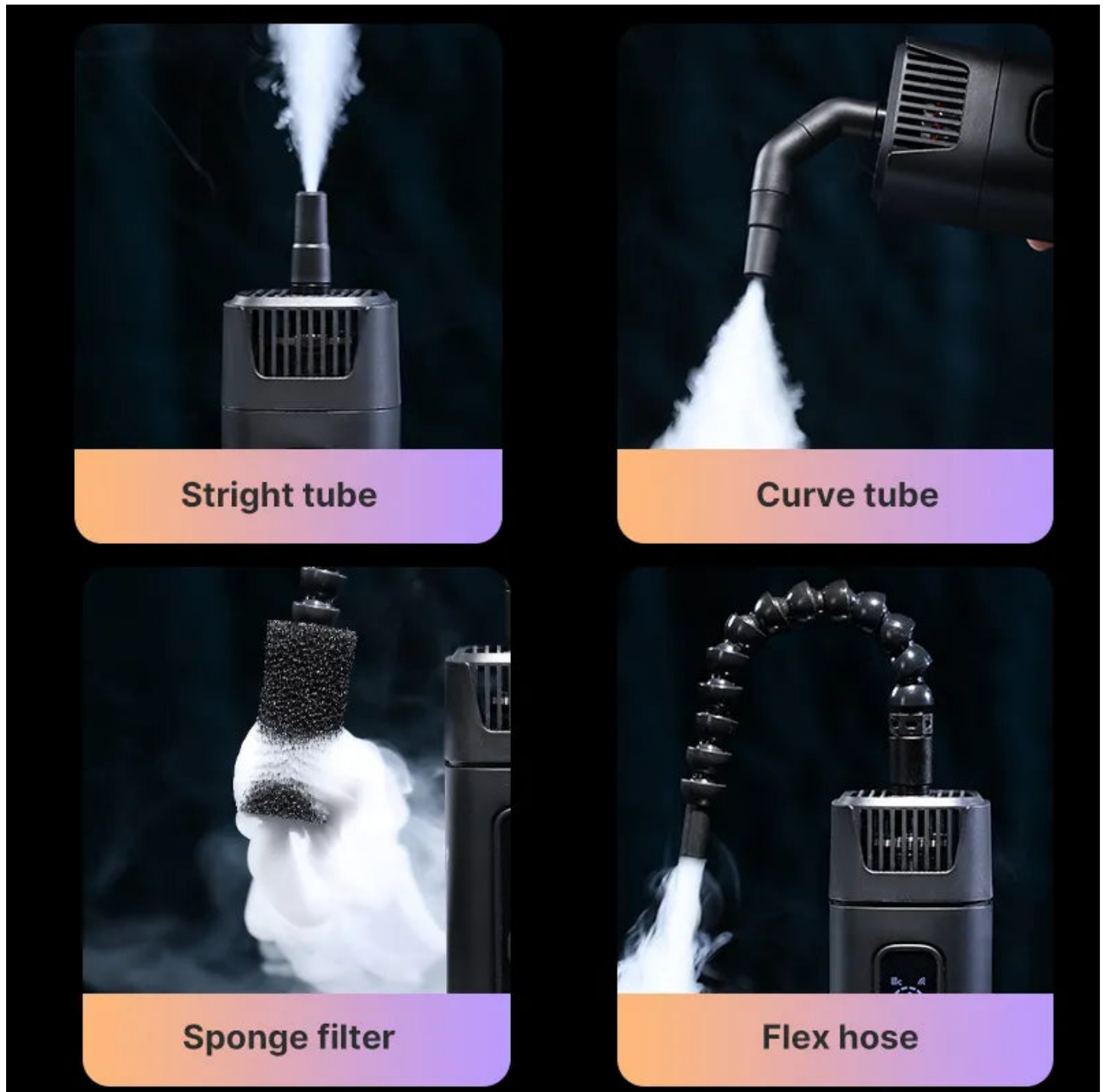

Understanding Portable Smoke Machines

Portable smoke machines are compact devices designed to produce a visible smoke or fog effect for various applications. They function by heating a special fluid, which evaporates and creates a dense vapor that mimics smoke. The versatility of these machines allows them to create different types of effects, ranging from subtle haze to thick fog, depending on the settings used. Portability is a key feature, as it allows users to easily transport the machine to various locations, making it ideal for on-the-go creativity. Furthermore, the ability to customize smoke output and density enhances the user experience, enabling artists to achieve their desired aesthetic in different settings, whether it's a photography studio, a small theater, or an outdoor event.

Key Features to Consider

When searching for a tailorable smoke effect portable machine, several essential features should be considered. First and foremost, adjustable output is crucial; it allows users to control the volume and density of the smoke, tailoring the effect to suit the environment or desired look. Ease of use is another important factor, as a user-friendly interface can facilitate quick adjustments during performances or shoots. The heat-up time is also significant; machines that warm up quickly can be more practical for spontaneous creative endeavors. Additionally, the customization options for effects—such as color or scent—can greatly enhance the creative possibilities, allowing users to tailor their smoke effects to match specific themes or moods.

Top Portable Smoke Machines for Customization

Evaluating various models of portable smoke machines reveals a landscape filled with options that cater to different creative needs. Many machines offer intuitive controls that allow users to easily adjust settings for customized outputs. For instance, some models provide the ability to switch between different types of smoke effects, allowing for seamless transitions during performances or shoots. Additionally, the size and weight of these machines vary, with some being lightweight and compact enough for easy transport while still delivering impressive output. Another common functionality is remote control operation, which can be particularly useful in settings where the machine needs to be discreet or hard to reach. Users often appreciate models that offer dual functionality, such as combining smoke effects with colored lights, enhancing the overall visual impact. The ease of cleaning and maintenance is another aspect to consider, as it can prolong the lifespan of the machine and ensure consistent performance.

Comparison Table of Features

When comparing different models, consider aspects like size, weight, output control, and unique functionalities. A simple comparison table can help you visualize these features, making it easier to determine which machine best meets your needs. Look for machines that balance portability with powerful output, ensuring that you can create impactful visuals without sacrificing convenience. Unique functionalities, such as programmable settings or integrated lighting, can further enhance your creative options, allowing for more dynamic presentations.

Practical Applications

The versatility of portable smoke machines allows them to be utilized in various creative contexts. In theater productions, they can set the mood for dramatic scenes, enhancing the emotional impact of performances. Photographers often use smoke machines to add depth and intrigue to their shots, creating stunning visual effects that captivate viewers. At parties and events, they can transform a simple gathering into an immersive experience, adding a touch of magic to celebrations. Additionally, filmmakers frequently employ smoke effects to create atmosphere and enhance special effects in videos, whether it's for action sequences or moody dialogue scenes. Each application showcases the potential of portable smoke machines to elevate creativity and storytelling.

Maximizing Your Creative Potential with Portable Smoke Machines

Choosing the right portable smoke machine for tailored effects is essential for anyone looking to expand their creative toolkit. With a myriad of options available, it's important to consider features that align with your specific needs and artistic vision. By exploring the capabilities of these machines, you can unlock new dimensions of creativity, experimenting with different settings and effects to enhance your projects. Whether you are a photographer, event planner, or performer, portable smoke machines offer endless possibilities for stunning visual storytelling. So, let your imagination soar and embrace the art of smoke!