

Unleash the Magic: Discover How Portable Smoke Machines Transform Your Events!

Portable smoke machines have become a staple in the event industry, captivating audiences and enhancing experiences with their enchanting visual effects. Whether it's a wedding, concert, or corporate gathering, these machines introduce a magical touch that can elevate any occasion. As their popularity continues to rise, event planners and hosts alike are discovering the immense value of having a [tailorable smoke effect portable machine](#) that can be tailored to suit specific needs. With customization options available, these machines not only create stunning atmospheres but also adapt seamlessly to the theme of your event, making them an essential tool for unforgettable celebrations.

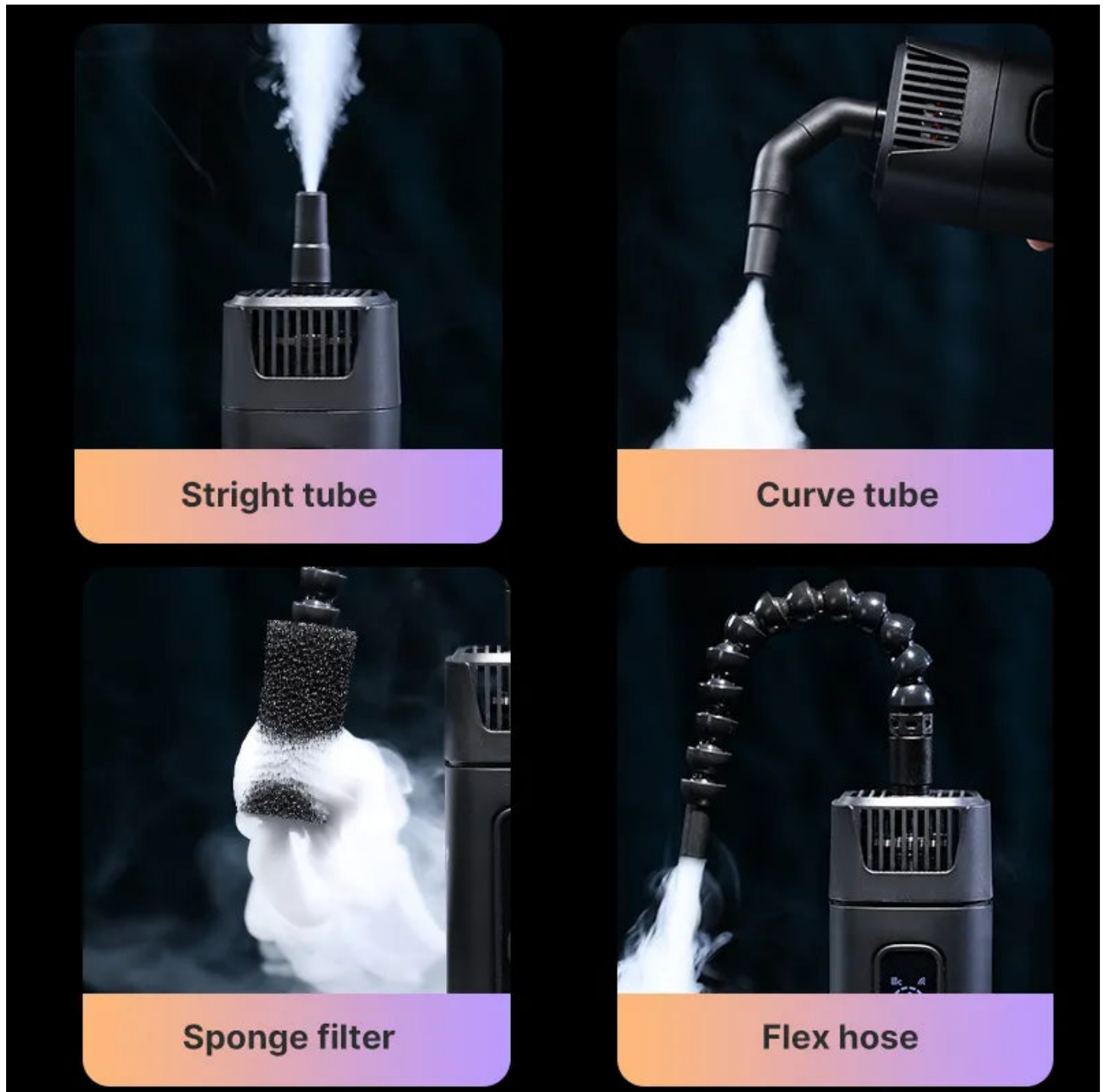

Understanding Portable Smoke Machines

At their core, portable smoke machines are devices designed to produce a dense vapor that simulates smoke. They work by heating a special fluid that generates a thick mist, creating an atmospheric effect that enhances lighting and visual presentations. There are several types of portable smoke machines available, ranging from simple units that generate white smoke to more advanced models capable of producing colored smoke or even fog effects. Typically, these machines are used in various settings, including theatrical performances, concerts, and private events, where they contribute to the overall ambiance and visual storytelling. Their portability allows for easy setup and operation, making them a favorite among event organizers.

Features of Tailorable Smoke Effect Machines

Tailorable smoke effect machines come equipped with features that offer unparalleled versatility. One of the key features is adjustable smoke output, allowing users to control the intensity of the effect based on the event's requirements. This is particularly useful for larger venues where a subtle haze may be needed, or for smaller settings where a more pronounced effect can create a dramatic atmosphere. Additionally, many of these machines offer a range of color options, enabling customization that aligns with the event's theme. Ease of transport is another significant feature, as these machines are typically lightweight and compact, making it simple to move them from one location to another. With these customizable features, event planners can create unique experiences tailored to any occasion.

Applications of Portable Smoke Machines in Events

The applications of portable smoke machines are vast and varied. In weddings, for instance, they can create a romantic ambiance during the first dance, enveloping the couple in a soft mist that enhances the moment's beauty. At concerts, these machines add a theatrical flair, accentuating lighting effects and engaging the audience. Theatrical performances benefit from smoke machines as they can set the mood and enhance storytelling through visual effects. Corporate events also use smoke machines to create dynamic presentations, drawing attention to key moments and making them more memorable. The transformative power of smoke machines is evident in how they can shift the atmosphere and elevate the overall experience of any event.

Choosing the Right Smoke Machine for Your Needs

Selecting the right portable smoke machine involves considering several factors to ensure it meets your specific needs. First and foremost, budget plays a crucial role in determining the type of machine you can invest in. It's important to find a balance between affordability and quality to guarantee a reliable performance. Venue size is another significant factor; larger venues may require machines with higher output capabilities to fill the space effectively, while smaller venues may benefit from more compact models. Additionally, consider the desired effects—whether you want a subtle haze or a dense fog, understanding your goals will help you choose a machine that delivers the right impact. By taking these factors into account, you can make an informed decision that enhances your event.

Enhancing Events with Portable Smoke Machines

In summary, portable smoke machines are powerful tools that can transform any event into a memorable experience. Their ability to create enchanting atmospheres through customizable effects makes them a worthwhile investment for event planners and hosts alike. By understanding the features, applications, and selection criteria for portable smoke machines, you can harness their potential to elevate your future gatherings. Whether you're planning a wedding, concert, or corporate event, consider how a tailorable smoke effect portable machine can enhance the magic of your occasion and leave a lasting impression on your guests.