

## Unleash the Magic: Discover the Captivating World of Controllable Fog Machines!

Fog machines have carved out a niche for themselves in the world of entertainment and event planning, making them a staple for parties, concerts, theater productions, and even haunted houses. The ability to transform an ordinary space into a mystical wonderland is something that captivates both event planners and attendees alike. With the rise of technology, fog machines have evolved significantly, leading to products that offer [36 controllable fog effects](#), allowing users to customize their fog production to suit various themes and atmospheres. This customization is not just about creating a visual spectacle; it's about enhancing the overall experience, making it more memorable and engaging.

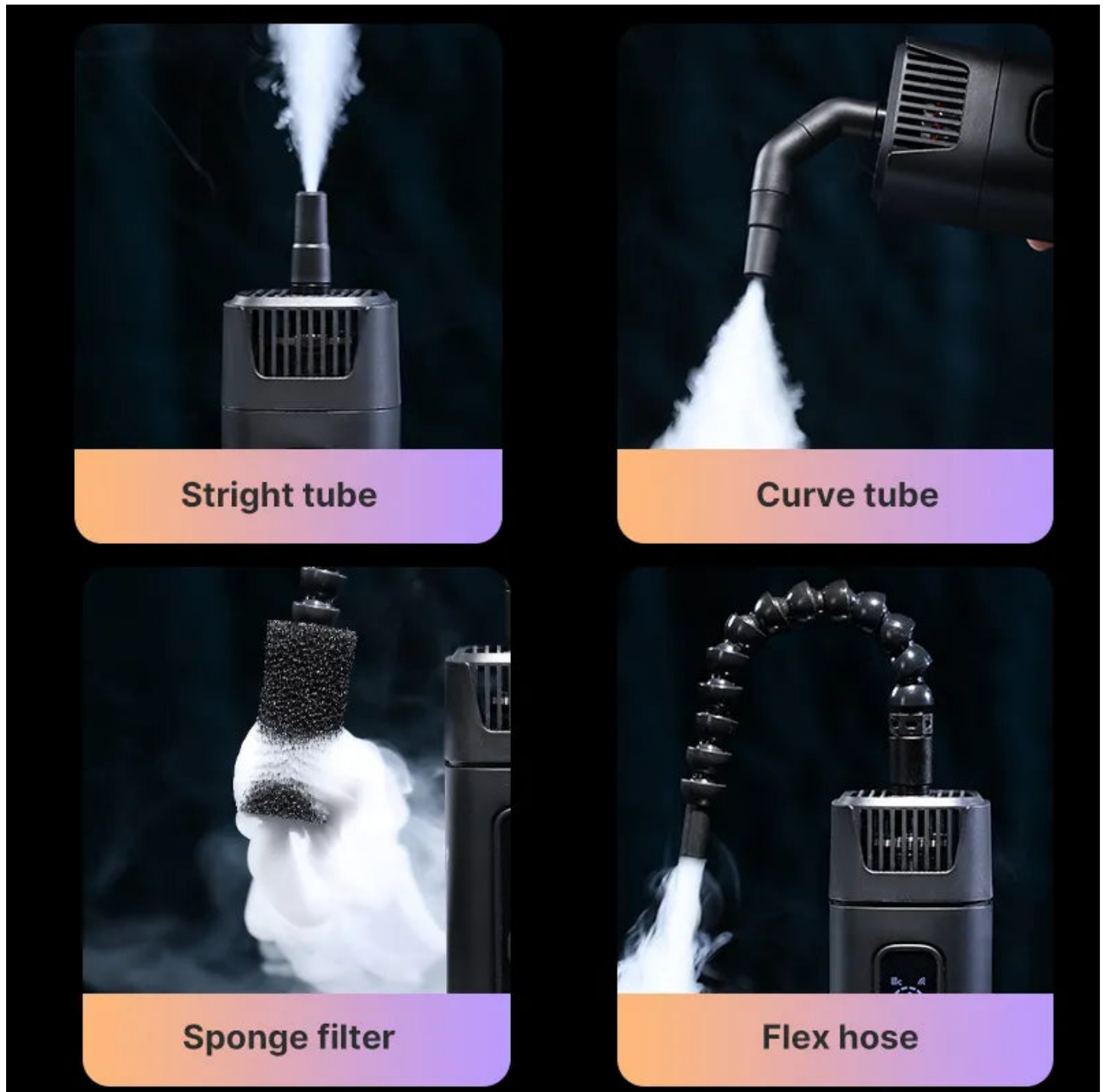

### Understanding Fog Machines

At their core, fog machines are devices that produce a dense vapor that resembles fog or smoke. They work by heating a special fluid—often a mixture of water and glycol or glycerin—which is then expelled into the air, creating a misty effect. There are several types of fog machines available on the market, including low-lying fog machines that create a ground-hugging effect, high-output machines for larger venues, and compact models suitable for smaller spaces. Each type has its own unique way of producing fog, and understanding these differences is key when considering how to use them effectively.

### 36 Controllable Fog Effects

The real magic happens when you dive into the 36 controllable fog effects that modern fog machines can produce. From gentle wisps that create an ethereal ambiance to thick clouds that evoke mystery and drama, the range is extensive. For instance, a slowly rolling fog can enhance a romantic setting, while rapid bursts of smoke can energize a concert or party atmosphere. The ability to control not just the amount of fog but also the timing and density of the effects allows event planners to set the perfect mood for their audience. Personal experiences shared by friends reveal how a carefully timed fog effect during a wedding dance made the moment unforgettable, highlighting the emotional impact these machines can have.

## **Benefits of Using Controllable Fog Machines**

The advantages of integrating controllable fog machines into events are numerous. One of the primary benefits is their versatility; they can be used in a variety of settings, from intimate gatherings to large-scale productions. The ease of use is another significant advantage, as many machines come with remote controls or DMX compatibility, allowing for seamless integration into light shows. Additionally, the atmospheric transformation that fog machines provide can significantly elevate the ambiance of any event. For instance, at a Halloween party, the right fog effect can create an eerie feeling that enhances the overall theme. Friends who've hosted events have shared stories of how the inclusion of fog turned a standard party into an immersive experience that left guests talking long after the event was over.

## **How to Choose the Right Fog Machine**

When it comes to selecting a fog machine with controllable effects, several factors should be considered. First and foremost, assess the size of the venue where the machine will be used; larger spaces may require machines with higher output capacities. Control options are also crucial; for those seeking precision, look for machines that offer remote control or DMX capabilities. Furthermore, it's essential to think about maintenance requirements—some machines may need regular cleaning or specific types of fog fluid to operate optimally. By weighing these factors carefully, users can find a fog machine that meets their needs and enhances their events.

## **Usage Tips and Safety Considerations**

Using fog machines effectively requires some practical tips and safety considerations. Firstly, always ensure proper ventilation in the area where the fog machine will be used, as excessive fog can cause visibility issues. It's also important to follow the manufacturer's guidelines regarding fluid types and machine operation to avoid malfunctions. One friend shared a particularly humorous anecdote about a fog machine they had at a party that malfunctioned, creating so much fog that guests momentarily lost each other in a cloud. While it made for a funny story, it served as a reminder to always test the machine beforehand. Additionally, consider the audience—ensure that those with respiratory issues are informed about the fog, as it can sometimes exacerbate certain conditions. With these precautions in mind, users can enjoy the benefits of fog machines safely.

## **Unlocking the Potential of Controllable Fog Machines**

In summary, controllable fog machines offer a unique and enchanting way to enhance any event, from weddings to concerts to spooky Halloween parties. Their ability to create diverse fog effects can completely transform the atmosphere, making experiences more memorable. By understanding how these machines work, their benefits, and how to use them safely, readers can unlock the potential of fog machines in their own events. Embrace the magic of controllable fog machines and let your creativity shine as you craft unforgettable experiences that leave a lasting impression on your guests.